

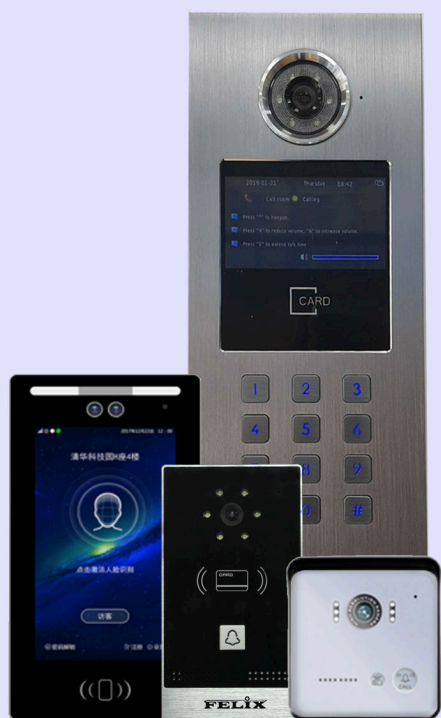

IP VIDEO INTERCOM SYSTEM

Products & Solutions



IP VIDEO INTERCOM SYSTEM WITH MOBILE APPLICATION

- User friendly and easy to use.
- Wide angle view support in mobile application.
- Picture Recording - still images of visitors can be recorded.
- Electric Lock release support from mobile phone.
- Smartphone or tablet can be used to respond to the visitors and unlock electric locks from anywhere.

FX-R133IP



- High resolution 7-inch indoor monitor.
- Operation: Touch screen display & manual button.
- Ultra thin design.
- Mobile application control.
- Cost effective color hands-free monitor.
- User friendly interface.
- High-definition video quality.
- Pre-video from door station allows you to see caller without answering.
- Digital intercom with PoE technology.

- Monitor the outdoor station and CCTV camera.
- Available to work with KNX protocol home automation system.
- English interface and guider operation.
- Room number, IP and password settings.
- Do not disturb option - Adjustable volume 1-15.
- 8 alarm zones and emergence help.
- Working voltage: DC 12-18V, max 400mA.
- Called by outdoor station, guard station, doorbell camera and other indoor monitors.
- Video, called, missed call, calling, alarm and message record view.
- Installation: Surface mounted.



FX-R231IP



- High resolution 7-inch touch screen display.
- Ultra thin design.
- Mobile application control.
- Cost effective color hands-free monitor.
- User friendly interface.
- High-definition video quality.
- Pre-video from door station allows you to see caller without answering.
- Digital intercom with PoE technology.

- Monitor the outdoor station and CCTV camera.
- Available to work with KNX protocol home automation system.
- English interface and guider operation.
- Room number, IP and password settings.
- Do not disturb option - Adjustable volume 1-15.
- 8 alarm zones and emergence help.
- Working voltage: DC 12-18V, max 400mA.
- Called by outdoor station, guard station, doorbell camera and other indoor monitors.
- Video, called, missed call, calling, alarm and message record view.
- Installation: Surface mounted.



FX-R101IP



- High resolution 10-inch wide touch screen display.
- Ultra thin design.
- Mobile application control.
- Fashional design with golden frame.
- User friendly interface.
- High definition video quality.
- Pre-video from door station allows you to see caller without answering.
- Digital intercom with PoE technology.

- Monitor the outdoor station and CCTV camera.
- Available to work with KNX protocol home automation system.
- English interface and guider operation.
- Room number, IP and password settings.
- Do not disturb option - Adjustable volume 1-15.
- 8 alarm zones and emergence help.
- Working voltage: DC 12-18V, max 400mA.
- Called by outdoor station, guard station, doorbell camera and other indoor monitors.
- Video, called, missed call, calling, alarm and message record view.
- Installation: Surface mounted.

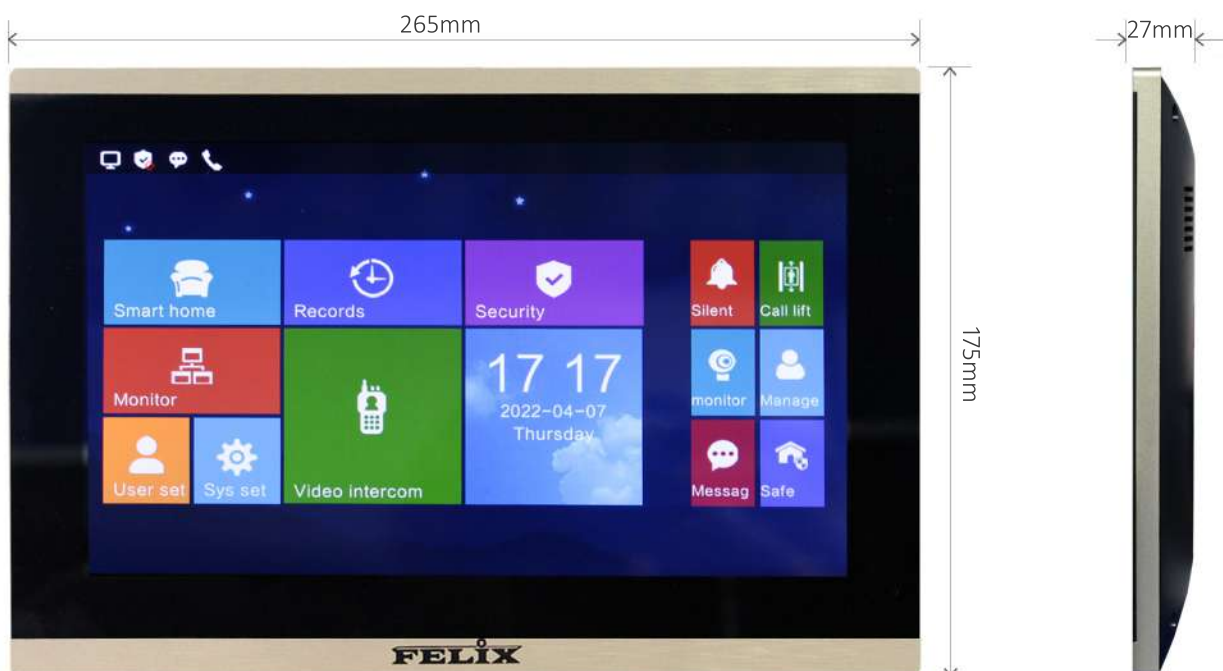

FX-D315-EF

Guests use the entrance outdoor panel by dialing the apartment number on the panel to call and speak with a tenant inside their unit via a apartment intercom station the resident will then be able to talk with the caller and choose to allow them in by pressing the door release button on their apartment intercom.



- Outdoor station with 4.3-inch display.
- Metal/Acrylic panel with stylish design.
- High resolution 2MP CMOS wide angle camera.
- Keyboard is designed with an automatic night light.
- Electric lock release support.
- Clear night vision with LED lights.
- Waterproof IP65 rating.
- Digital intercom with PoE technology.

- IC/ID reader for access control and proximity card add or delete option.
- Calling, intercom & message leaving.
- System update online & WAN/LAN.
- Master or slave for option.
- Top chip design and low temperature work affordable.
- Working voltage: DC 12V-18V.
- Working temp: -40°C ~ 80°C.
- Installation: Flush mounted.
- Product size: 365*140*50mm.
- Installation size: 347*127*42mm.



FX-D325IP

The independent small video color entrance panel is for installation on the front of the single apartment or for the villa entrance. This elegant metal and acrylic panel brings a classic design, and provides the following functions: Push button with stable performance, proximity card access, ability to call and communicate directly with the indoor unit.

- Small door bell for villa and single apartment.
- Elegant Metal/Acrylic panel with compact design.
- High resolution 2MP CMOS wide angle camera.
- Clear night vision with white LED lights.
- Electric lock release support.
- Waterproof IP65 rating.
- Digital intercom with PoE technology.



- Card reader for access control system.
- Calling and intercom.
- Night light compensation.
- Top chip design and low temperature work affordable.
- Working power: DC 12V-18V,
- Working temperature: -10°C ~55°C.
- Standby current: ≤ 100mA.
- Working current: ≤ 400mA.
- Installation: Wall mounted.
- Product size: 154*85*46mm.

FX-D323IP-E

- Small door bell for villa and single apartment.
- Elegant acrylic panel with compact design.
- High resolution 2MP CMOS wide angle camera.
- Clear night vision with white LED lights.
- Electric lock release support.
- Waterproof IP65 rating.
- Digital intercom with PoE technology.
- Working power: DC 12V-18V.
- Working temp: -10°C ~ 55°C.
- Standby current: ≤100mA.
- Working current: ≤400mA.
- Installation: Wall mounted.



FX-D326IP-EF

- Exclusive outdoor panel with 10-inch touch display.
- Tempered glass for more protection.
- High resolution 2MP CMOS camera wide angle camera.
- Clear night vision with white LED lights.
- Electric lock release support.
- System update online & WAN/LAN.
- Waterproof IP65 rating.
- Face recognition for option.
- Digital intercom with PoE technology.
- Functions: IP protocol, calling, intercom, snap picture, reader, door sensor alarm, unlocking replay, exit switch and security port.
- Working voltage: DC 12V/2A.
- Working temp: -20°C ~ 55°C.
- Product size: 339*190*36.5mm.
- Installation: Surface mounted.



Apartment structure



Villa structure

